

Quick Start Guide
TP80V

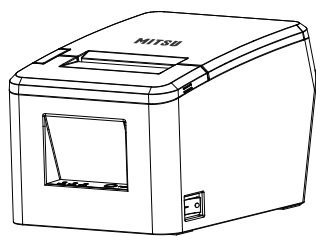

Packing List

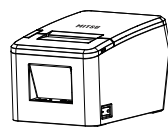

Printer



USB Cable



Power Cord



Power Adapter

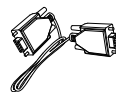

Serial Cable



Quick Start Guide



Roll Paper



CD

⚠Note: The items in the package depend on the actual order.

Appearance

■ Front

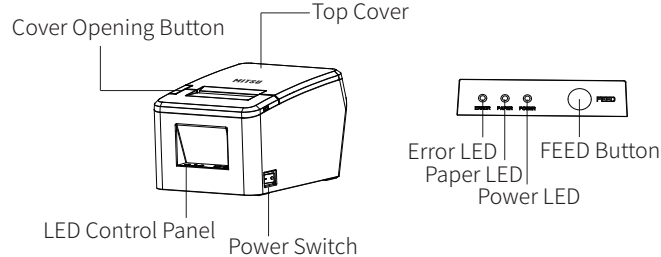

■ Back

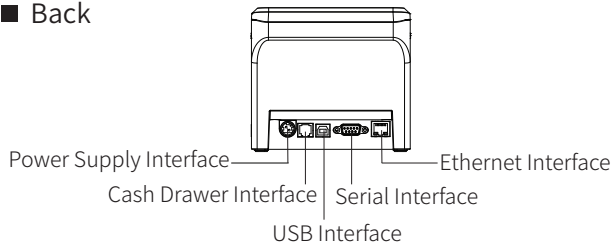

■ Opening Top Cover

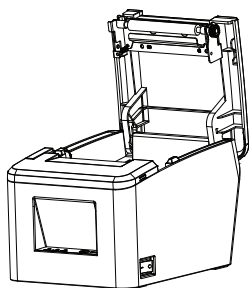

Paper Loading

1. Press the cover opening button to open the top cover.
2. Remove the used roll paper core, if any.

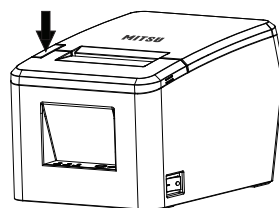

3. Load the roll paper in the correct direction as shown below.

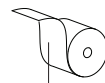
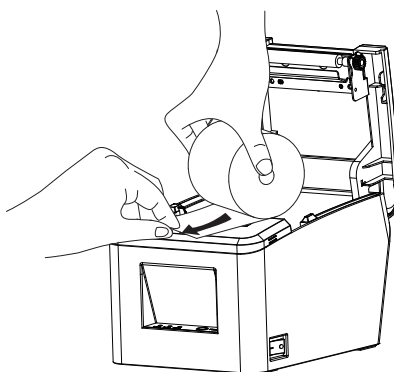

Thermosensitive Layer

4. Pull out some paper, and close the top cover.

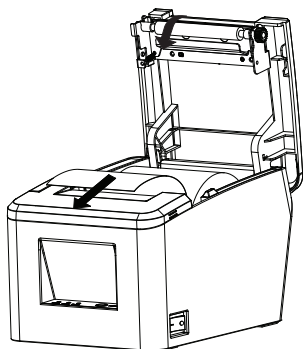

5. Tear the extra paper.

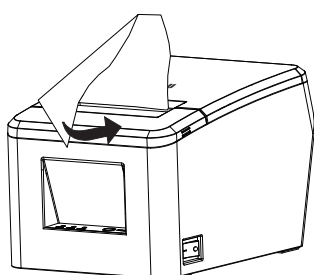

Power Supply

1. Make sure the printer power is turned off.
2. Connect power adapter with printer.
3. Connect power adapter with power cord.
4. Plug the other side of power cord into the socket outlet.

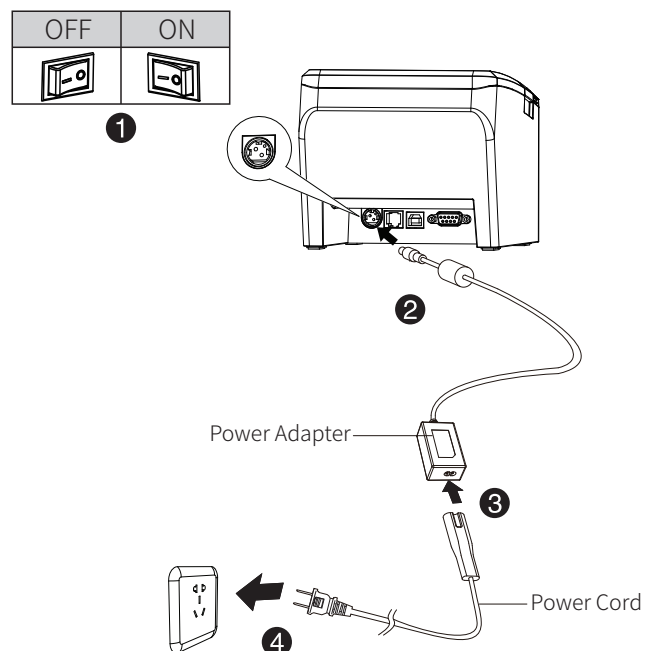

⚠ Note: The power adapter and power cord vary by local or region.

Interface

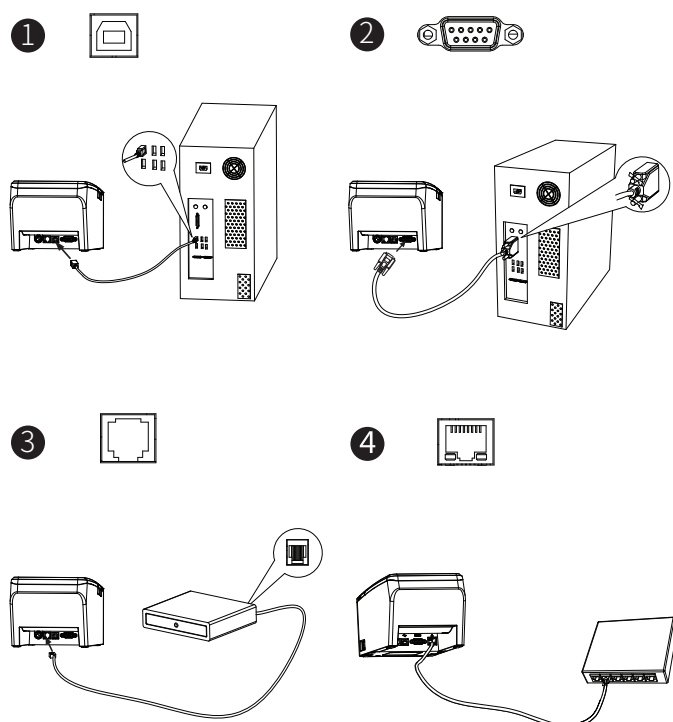

⚠ Caution: This is a Class A product. In a domestic environment this product may cause radio interference in which the user may be required to take adequate measures.

Troubleshooting for Cutter Jam

1. When cutter jam occurs, do not press the cover opening button to avoid damaging the blade.
2. Fix the printer by one hand and press either side of the convex bars by the other hand. Push up and open the front cover.

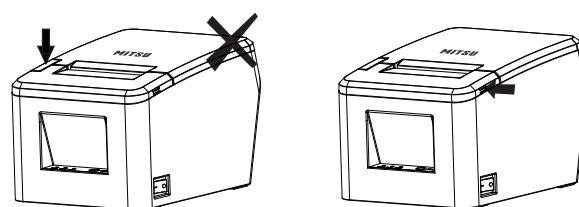

3. Please rotate the gear until the blade returns to its normal position, as shown in Figure 2.

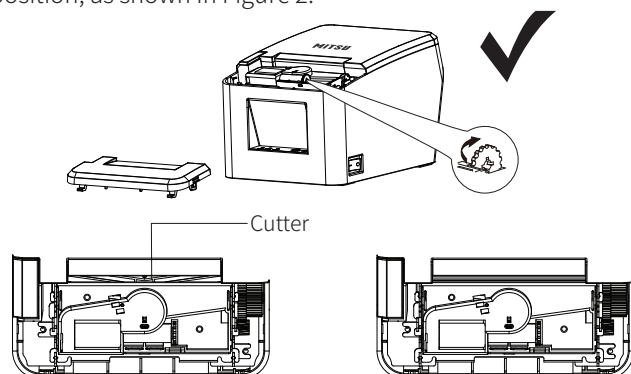

When cutter jam occurs, the cutter does not retreat back and can be seen.

Figure 1

Cutter retreats back totally and cannot be seen.

Figure 2